

- In addition to routine checks for each use, PPE should regularly undergo a detailed inspection by a competent person. Petzl recommends an inspection every 12 months and after any exceptional event in the life of the product.
  - PPE inspection should be conducted with the manufacturer's Instructions for Use.
- Download the instructions at [PETZL.COM](https://www.petzl.com).

## GRIGRI BELAY DEVICES



### 1. Known product history

Any PPE showing unexpected degradation should be quarantined, pending a detailed inspection.

The user should:

- Provide precise information on the usage conditions.
- Report any exceptional event regarding his PPE.

(Examples: fall or fall arrest, use or storage at extreme temperatures, modification outside manufacturer's facilities...).

### 2. Preliminary observations

Verify the presence and legibility of the serial number and the CE mark.

**Note:** the serial number code on our products is evolving. Two types of code will coexist. See below for details on each serial number code.

Code A:

00 000 AA 0000

Year of manufacture	.....
Day of manufacture	.....
Name of Inspector	.....
Incrementation	.....

Code B:

00 A 0000000 000

Year of manufacture	.....
Month of manufacture	.....
Batch number	.....
Incrementation	.....

Verify that the product lifetime has not been exceeded.

Compare with a new product to verify there are no modifications or missing parts.

### 3. Hareketli yan plakanın kontrol edilmesi

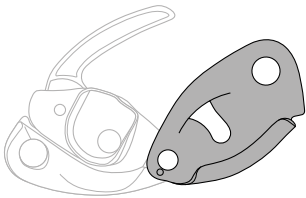

- Hareketli yan plakanın durumunu kontrol edin (işaretler, deformasyon, kirlenme, çatlaklar, aşınma ...). Yan plakada bir delik görürseniz ürünü emekliye ayırın.

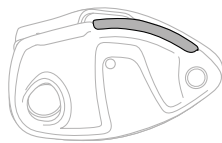

- GRIGRI + 'da aşınma plakasının durumunu kontrol edin.

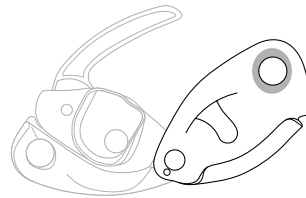

- Bağlantı deliğinin durumunu kontrol edin (işaretler, deformasyon, çatlaklar, korozyon ...).

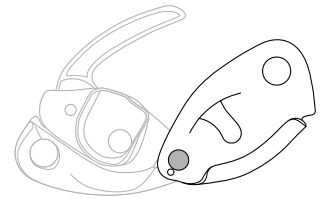

- Perçinlerin durumunu kontrol edin (izler, deformasyon, çatlaklar, korozyon, boşluk ...).

#### 4. Checking the condition of the frame

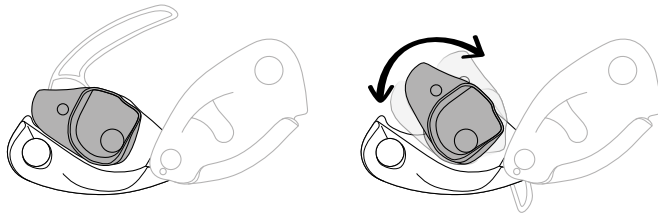

- Check the condition of the cam and its axle (marks, deformation, fouling, cracks, corrosion...). Check the cam's mobility.

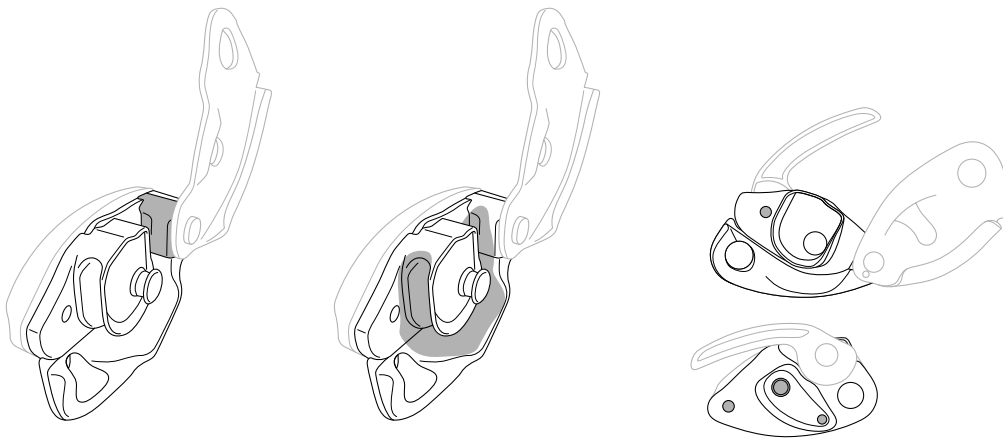

- Check the condition of the friction plate (marks, deformation, fouling, cracks...).
- Verify the absence of foreign objects (sand...) or lubricant on the rope channel.
- Check the condition of the rivets (marks, deformation, cracks, corrosion, absence of play...).

#### 5. Checking the condition of the handle

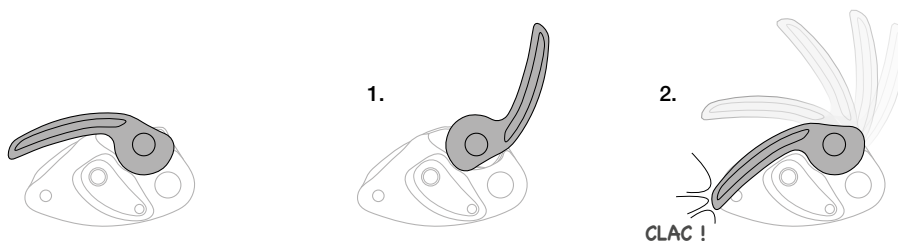

- Check the condition of the handle (marks, deformation, cracks...).
- Check that the handle return spring is working properly.

## 6. Checking the condition of the selector knob (GRIGRI + only)

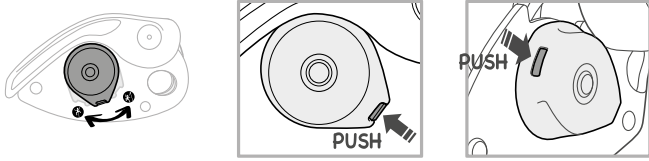

- Check the condition of the selector knob (marks, deformation, cracks...).

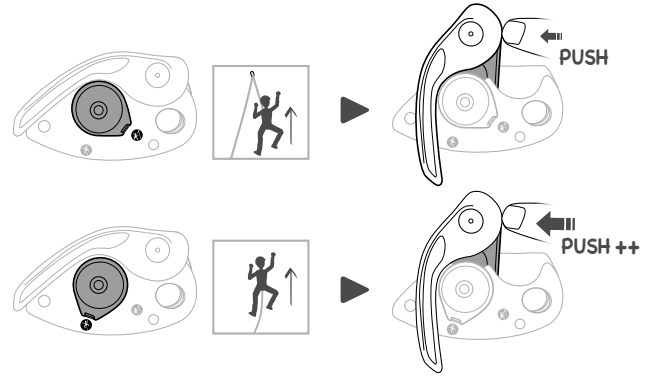

- Check the selector knob for proper function. (When rotated, the cam offers more resistance in the lead climbing position than in the top-rope position).

## 7. Function check

- Do a function check with the device on the harness. Do this test with your smallest diameter rope.

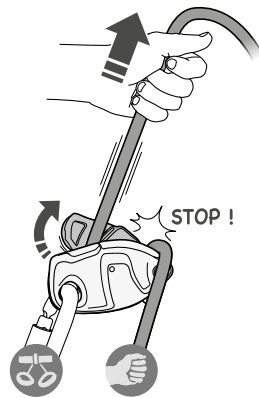

1. Pull on the climber-side rope; the device should lock the rope.

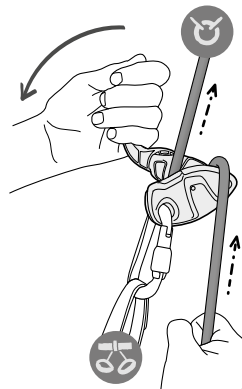

2. Hang from a low height. Pull the handle while holding the brake-side rope. The rope must slide through the device.

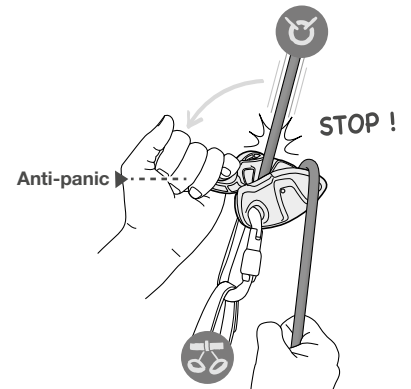

3. Checking the anti-panic on the GRIGRI +. Hang from a low height. Pull the handle QUICKLY while holding the brake-side rope. The rope should be locked.

## 8. Appendix: examples of GRIGRI that are worn, or that should be retired

- Bent GRIGRI



- Perforated moving side plate



- Bent handle



- Broken handle



- Worn-out rope channel



- Broken handle



- Rope channel

